

# LapStacker® XD

## Installation Guide

Congratulations and thank you for choosing to install a LapStacker on your wheelchair.

Please read this installation guide carefully to ensure your LapStacker is installed and used correctly and safely.

<b>Contents</b>	<b>Page</b>
<b>Warnings</b> .....	<b>2</b>
<b>LapStacker® Installation</b> .....	<b>4</b>
<b>Further Information</b> .....	<b>9</b>

By using your LapStacker you agree to the terms of our Warranty and Product Disclaimer which can be read online at <https://adaptdefy.com/pages/lapstacker-warranty-disclaimer>

### Warnings - General

- LapStacker is not a seatbelt, safety device, or medical device.
- LapStacker is designed as an aid only.
- Do not use your LapStacker to secure people or animals.
- Carefully place and monitor items as they can still move, even when secured.
- Do not exceed any wheelchair manufacturer's guidelines for loading or attachment use.
- Do not apply excessive force to the LapStacker or its components. It is not designed to support body weight.
- Do not release the LapStacker straps and allow them to retract without control, as this may cause damage over time.
- In no event shall our company be liable for any direct, indirect, punitive, incidental, special, or consequential damages to property or life resulting from the use or misuse of our products.
- Do not lift or move the wheelchair by the LapStacker straps, as this may cause damage.

### Warnings - Maintenance

- Clean components using a damp cloth only. Avoid using chemical cleaners on plastic surfaces.
- To clean the straps, use water and a cloth. Fully extend the straps to dry, and ensure they are completely dry before retracting.

### Warnings - Installation

- If moving existing wheelchair components (e.g. armrests, leg restraints), ensure they are reinstalled securely to avoid failure and injury.
- The LapStacker Retractor is not designed for submersion. Water damage may void the Warranty.
- LapStacker is not designed for use in environments below -15°C (5°F) or above 45°C (113°F). Use outside this range may cause damage and may void the warranty.
- Do not over-tighten the tension straps during installation, as excessive force may damage the components and will void the warranty.

### Warnings - Injury

- Do not use your LapStacker to secure items that could cause injury, such as sharp, hot or heavy objects.
- Over-tightening the LapStacker straps may cause loss of circulation, pressure injury, or damage to items being carried.
- Avoid contact with your LapStacker during transfers to prevent injury or damage.
- Avoid extended use, which may cause loss of circulation or pressure injury.
- Do not stack items too high as this may reduce visibility and lead to a collision that causes injury.



### LapStacker Assembly

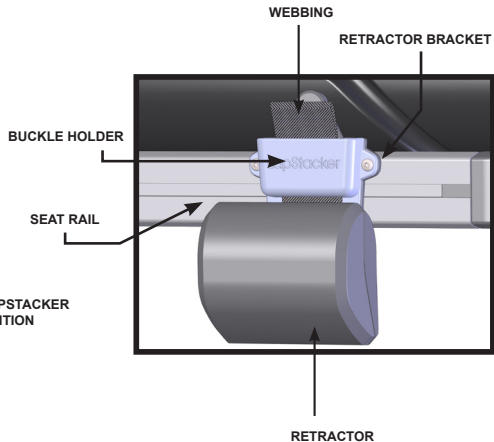

Ideally, your LapStacker is positioned centrally in relation to where items will be carried.

## 1. Choose Mounting Hardware

- Check the table to confirm the correct screw and nut sizes for your wheelchair brand.
- LapStacker XD comes pre-installed with the M6 x 12 screws and 14 x 10 x 5 nuts.
- If the pre-installed screws and nuts are correct for your wheelchair, proceed to the next step
- If not, remove them and install the correct screws and nuts into the retractor brackets, ready for the next step.

Brand	Screw	Nut
Amylior	M6 x 16	16 x 16 x 4
iBOT	M6 x 16	16 x 16 x 4
Invacare	M6 x 16	16 x 16 x 4
Merits	M6 x 14	16 x 16 x 4
Ottobock	M6 x 16	16 x 16 x 4
Permobil	M6 x 12	14 x 10 x 5
Quantum	M6 x 14	16 x 16 x 4
Quickie	M6 x 16	14 x 10 x 5

## 2. Slide onto the Seating Rail (T-slot).

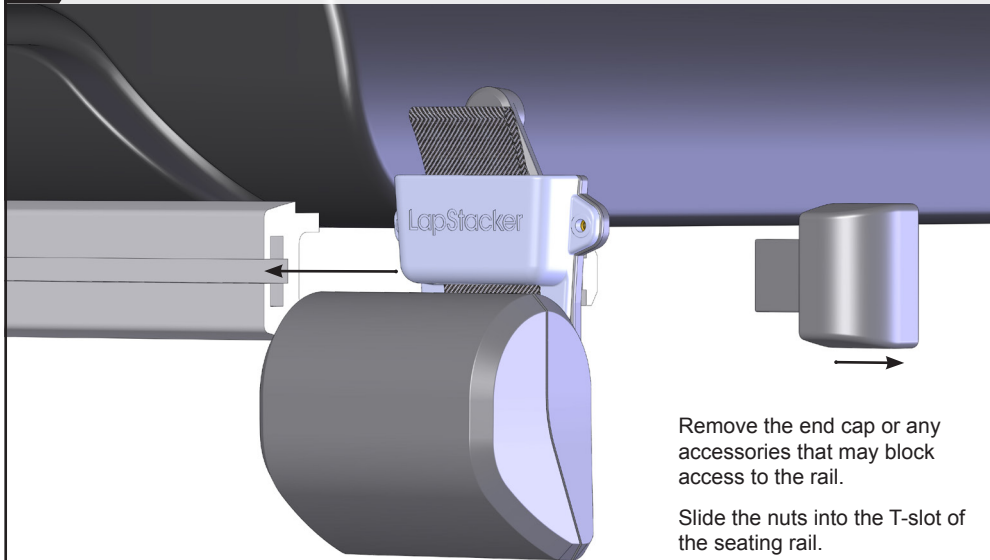

### 3. Adjust position and tighten screws.

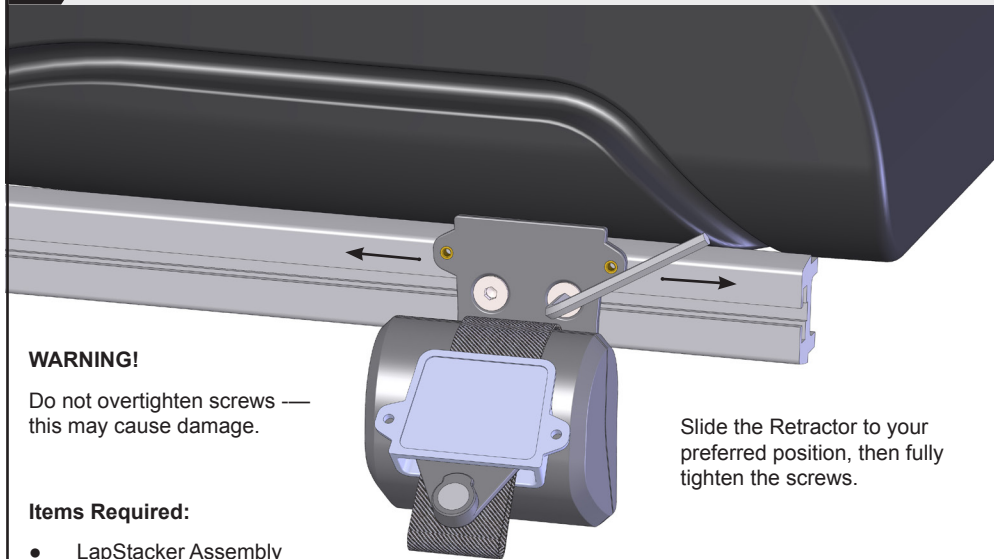

#### **WARNING!**

Do not overtighten screws — this may cause damage.

#### **Items Required:**

- LapStacker Assembly
- 4.0mm Allen Key (largest key supplied)

Slide the Retractor to your preferred position, then fully tighten the screws.



#### 4. Attach Buckle Holder.

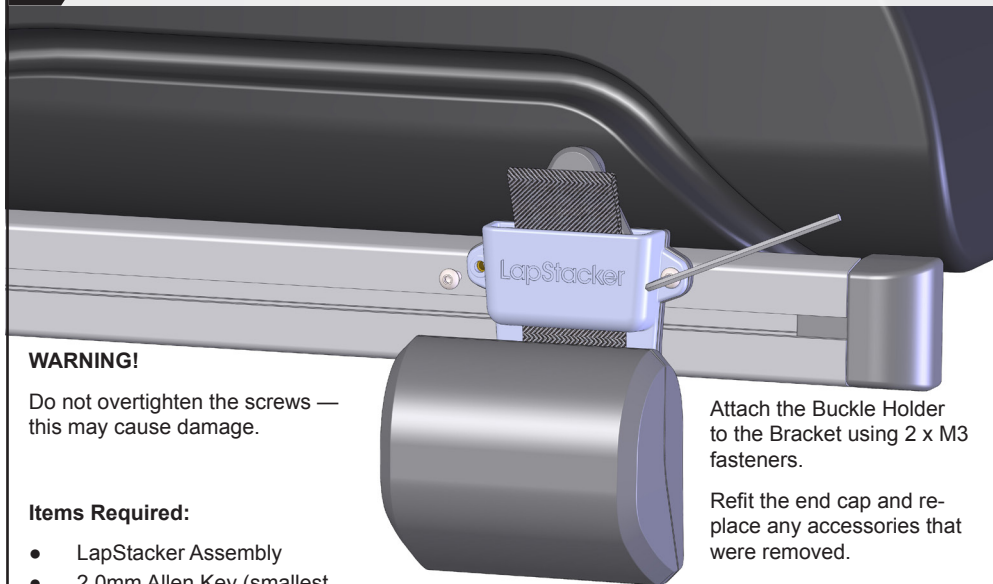

##### **WARNING!**

Do not overtighten the screws — this may cause damage.

##### **Items Required:**

- LapStacker Assembly
- 2.0mm Allen Key (smallest key supplied)

Attach the Buckle Holder to the Bracket using 2 x M3 fasteners.

Refit the end cap and replace any accessories that were removed.

Repeat for other side.

≥ adaptdefy®

adaptdefy.com  
info@adaptdefy.com



@adaptdefy



@adaptdefy



@adaptdefy



@adaptdefy

Scan for installation and  
troubleshooting tips.

